



IQ Easy LP Static Neutralizing Bar

THE NEXT LEVEL OF EASY

The first of its kind, the IQ Easy LP Bar is engineered to be the most compact and powerful ionizing bar with built-in high voltage power. Its high output power allows it to achieve the lowest possible residual charges in a wide range of applications.

In high-speed web applications, it offers superior close-range ionization with the ability to mount to ground for unsurpassed performance in tight spaces.

In assembly applications, it provides long-range, balanced ionization—equal quantities of positive and negative ionization—for advanced performance where decay time tests are required.

- Built-in high voltage power supply—10 times more output power than competitor bars
- Compact design at 3/4" (19 mm) height
- Mounts to ground for easy installation in tight spaces
- Rugged industrial design with long-life tungsten emitter pins
- Offers superior close-range ionization for high-speed webs traveling up to 3,000 fpm—can operate at 1" mounting distance, unlike other bars designed with specific distance requirements
- Provides balanced ionization for assembly applications requiring decay tests—cleanroom rating up to Class 1000 (ISO 6)
- Available in over 30 different lengths from 9.5" (241 mm) to 85" (2,184 mm)
- IP66 safety rating for protection against light splash

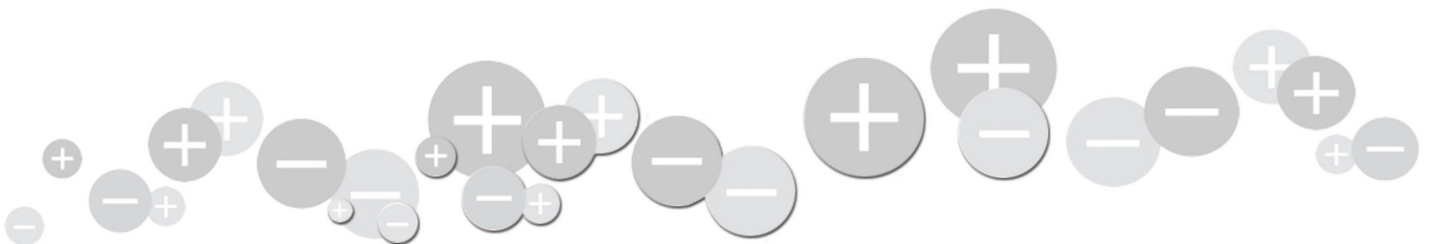

Specifications	
Input Voltage	24 VDC
Input Current	0.75A (max)
Input Connection	5-pin M12 (A-coded) male receptacle
Output Voltage	6 kV
Output Current	30 μ A per emitter (max) to ground
LED Indicator	Green (steady) = Operation Green (flashing) = Standby Green (flickering) = Communication Red (steady) = Fault Red (blinking) = Communication Failure
Ingress Protection Class	IP66
Operating Environment	131°F [55°C] (max); 70% RH, no dewing permissible (max)
Target Material Speed	>1600 fpm [488 m/min] (distant dependent)
Operating Distance	1-5" [25-125 mm]
Dimension	1.34" x 9.45-85.04" x 0.75" [34 x 240-2160 x 19.1 mm]
Enclosure	Glass fiber reinforced polycarbonate
Compliance	RoHS Compliant, ETL Approved

The Most Advanced Technology & Performance

The integrated high-voltage power supply of the IQ Easy LP has 10 times the output power of competitor bars which provides a consistent high-level of performance while also limiting the current at the pins for user-safety. This is unlike competitive balanced ionization products, which while balanced, have inadequate power for industrial applications. It also requires no compressed air.

The IQ Easy LP Bar can be used stand-alone with two status LED indicator lights for POWER (green) or FAULT/FAILURE (red). However, when connected to the IQ Power Control Station, the IQ Easy LP provides the most advanced communication and monitoring in static control.

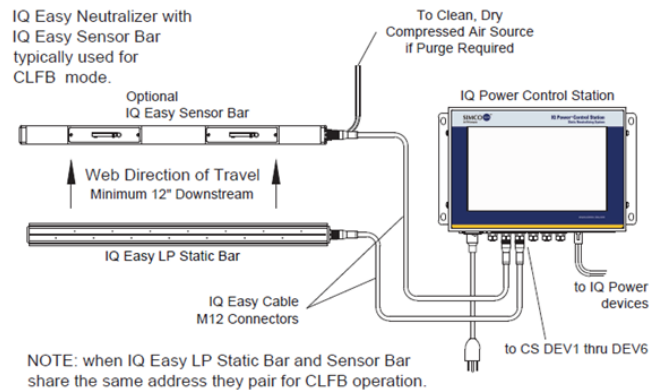

IQ Easy LP's high output power means the lowest possible residual charges in a wide range of applications.

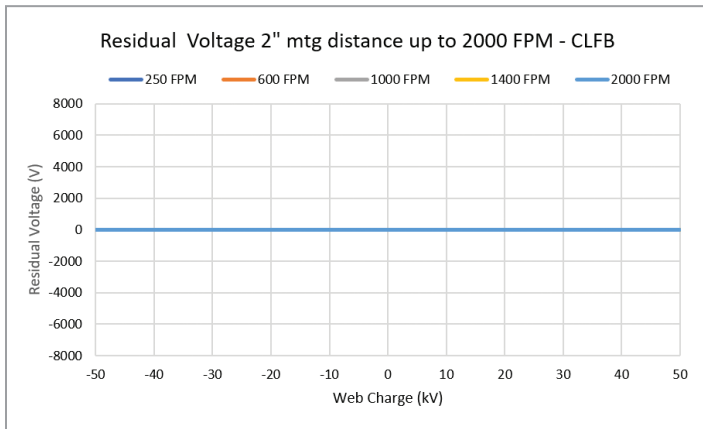

* Closed-loop Feedback (CLFB) mode requires IQ Easy Modular Sensor Bar and Control Station.

IQ Easy LP outperforms competitive ionization products.

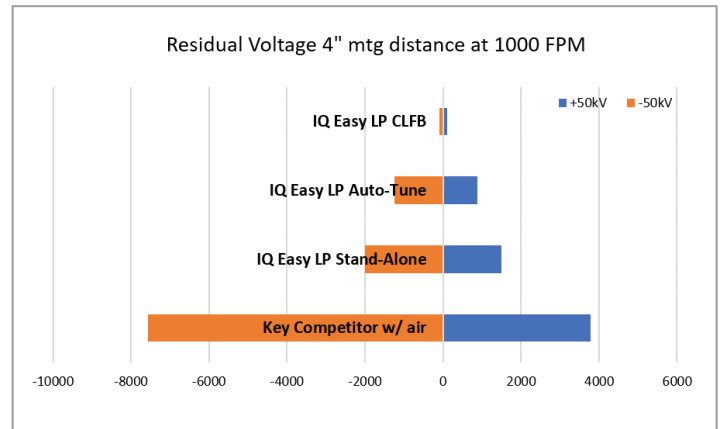

* Closed-loop Feedback (CLFB) mode requires IQ Easy Modular Sensor Bar and Control Station.

* Auto-Tune mode requires Control Station.

* Stand-Alone mode is factory default setting, no Control Station needed.



Simco-Ion

2257 North Penn Road
Hatfield, PA 19440-1998

Tel: 800.203.3419 (in USA)
Tel: 215.822.6401

customerservice@simco-ion.com
www.simco-ion.com

P/N 5201317 Rev. C
© 2023 Simco-Ion - All rights reserved.
Specifications are subject to change without notice.

w o r l d w i d e l e a d e r s i n s t a t i c c o n t r o l